

4

3

2

1

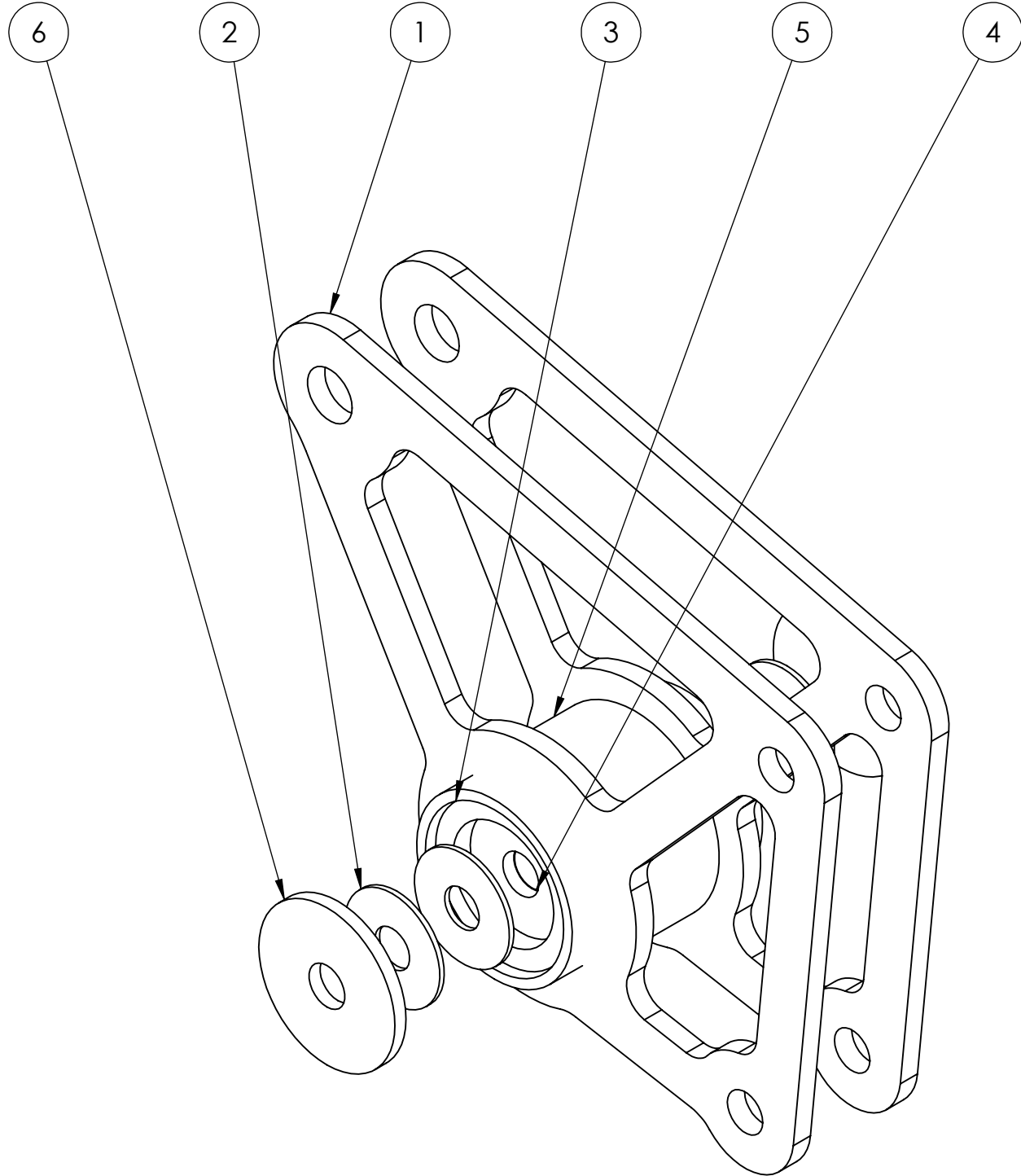

ITEM NO.	PART NUMBER	DESCRIPTION	QTY.
1	-	Rear Bellcrank Plate	2
2	-	Thrust Bearing Spacer	4
3	5909K951	Thrust Bearing	2
4	-	Radial Bearing Spacer	1
5	-	Bearing Housing & Radial Bearing	1
6	-	End Caps	2

GENERAL NOTES
 1. INTERPRET DIMENSIONS AND TOLERANCES PER ASME Y14.5M-1994
 2. PARTS ARE TO BE CLEAN AND FREE OF OIL, GREASE, AND OTHER CONTAMINANTS
 3. DIMENSIONS INCLUDE ANODIZING, ELECTROPLATING, AND CHEMICALLY APPLIED FINISHES
 4. UNLESS SPECIFIED OTHERWISE, DEBURR AND BREAK ALL SHARP EDGES, MAX 0.010". ALL TURNED INTERNAL RELIEF FILLETS SHALL NOT EXCEED 0.015" MAX.

UNLESS OTHERWISE SPECIFIED:

PRIMARY UNITS: MILLIMETERS
[SECONDARY UNITS]: INCHES

TOLERANCES:

X.	±0.5 [0.020]
X.X	±0.25 [0.010]
X.XX	±0.125 [0.005]
X.XXX	±0.0125 [0.0005]
ANGULAR	±0.5 DEG

MATERIAL

-

FINISH

ANODIZED

DO NOT SCALE DRAWING

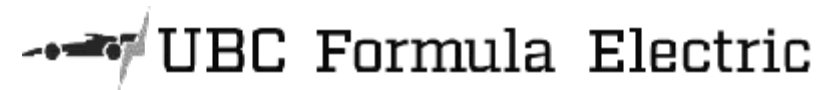

NAME		DATE	TITLE:	
DRAWN	AIDAN SOMANI	2026-05-03	Rear Bellcrank Assembly	
CHECKED	-		SIZE	REV
COMMENTS:			B	A
			PART NUMBER	SHEET 1 OF 2
			SU-6100-1	
			SCALE: 1:2	

3

2

1

4

3

2

1

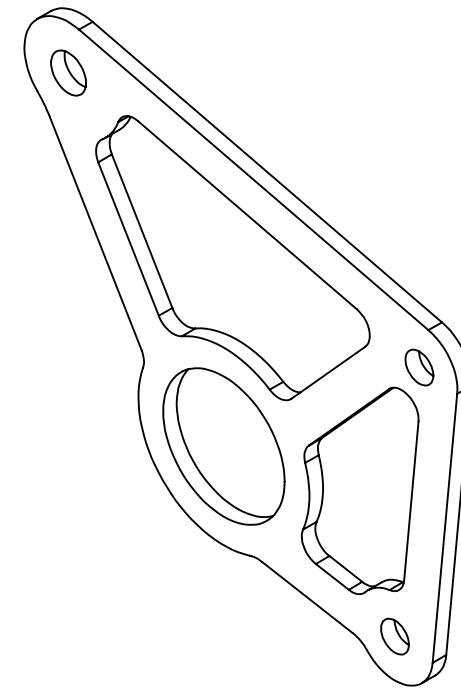
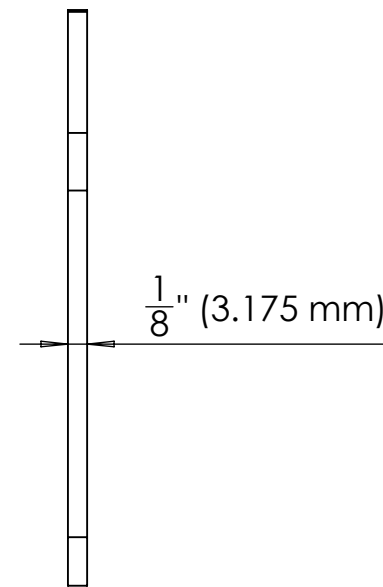
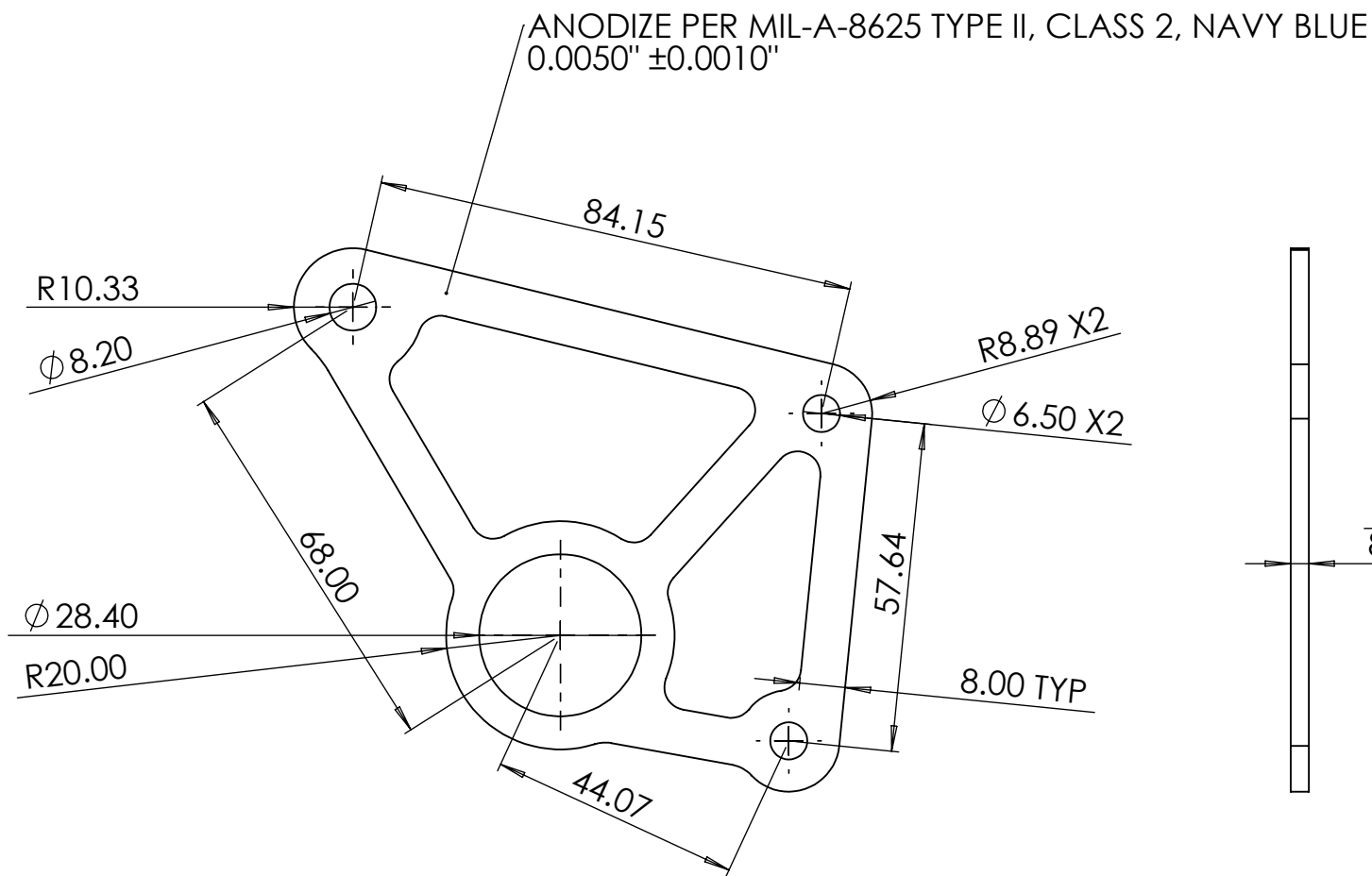

GENERAL NOTES

1. INTERPRET DIMENSIONS AND TOLERANCES PER ASME Y14.5M-1994
2. PARTS ARE TO BE CLEAN AND FREE OF OIL, GREASE, AND OTHER CONTAMINANTS
3. DIMENSIONS INCLUDE ANODIZING, ELECTROPLATING, AND CHEMICALLY APPLIED FINISHES
4. UNLESS SPECIFIED OTHERWISE, DEBURR AND BREAK ALL SHARP EDGES, MAX 0.010". ALL TURNED INTERNAL RELIEF FILLETS SHALL NOT EXCEED 0.015" MAX.

UNLESS OTHERWISE SPECIFIED:

PRIMARY UNITS: MILLIMETERS
[SECONDARY UNITS]: INCHES

TOLERANCES:

X.	±0.5 [0.020]
X.X	±0.25 [0.010]
X.XX	±0.125 [0.005]
X.XXX	±0.0125 [0.0005]
ANGULAR	±0.5 DEG

MATERIAL
7075-T6 ALUMINIUM

FINISH
AS MACHINED

DO NOT SCALE DRAWING



	NAME	DATE	TITLE:	
DRAWN	AIDAN SOMANI	2026-05-03	Rear Bellcrank Plate	
CHECKED	-			
	COMMENTS:	SIZE	PART NUMBER	REV
		B	SU-61001-AA	A
		SCALE: 1:1.25		SHEET 2 OF 2

3

2

1